



CENTRAL VACUUM

OWNER'S MANUAL

FOR HOUSEHOLD USE ONLY

Please read this document carefully before installing
and/or using your vacuum cleaning system.

Model : _____

Serial No : _____

IMPORTANT SAFETY INSTRUCTIONS

When using an electrical appliance, basic precautions should always be followed, including the following.

Read all instructions before using this appliance.

WARNING

To reduce the risk of fire, electric shock, or injury:

1. Do not leave appliance when plugged in. Unplug from outlet when not in use and before servicing.
2. Do not use outdoors or on wet surfaces.
3. Do not allow to be used as a toy. Close attention is necessary when used by or near children or infirm persons. This appliance is not intended for use by persons (including children) with reduced physical, sensory or mental capabilities, or lack of experience and knowledge, unless they have been given supervision or instruction concerning the use of the appliance by a person responsible for their safety.
4. Use only as described in this manual. Use only manufacturer's recommended attachments.
5. Do not use with damaged cord or plug. If appliance is not working as it should, has been dropped, damaged, left outdoors, or dropped into water, return it to a service center.
6. Do not pull or carry by cord, use cord as a handle, close a door on cord, or pull cord around sharp edges or corners. Keep cord away from heated surfaces.
7. Do not unplug by pulling on cord. To unplug, grasp the plug, not the cord.
8. Do not handle plug or appliance with wet hands.
9. Do not put any objects into openings. Do not use with any opening blocked; keep free of dust, lint, hair, and anything that may reduce air flow.
10. Keep hair, loose clothing, fingers, and all parts of body away from openings and moving parts.
11. Do not pick up anything that is burning or smoking, such as cigarettes, matches, or hot ashes.
12. Do not use without dust bag and/or filters in place, except model GA-100.
13. Turn off all controls before unplugging.
14. Use extra care when cleaning on stairs.
15. Do not use to pick up flammable or combustible liquids such as gasoline or use in areas where they may be present.
16. Connect to a properly grounded outlet only. See Grounding Instructions.

TABLE OF CONTENTS

Schematic – GA-40 model	6
Schematic – Other models	7
INSTALLATION	
Unit Installation	8
Dos & Don'ts	9
Muffler Installation	12
Electric Connections	15
Grounding Instructions	16
Low Voltage Connections	17
OPERATING INSTRUCTIONS	
Hose Hook-up & Inlets	18
Progressive start	19
Automatic stop	19
LED Indicator	19
Information center	20
MAINTENANCE	
Motor	21
Maintenance – GA-40 model	21
Maintenance – Other models	22
Maintenance – GA-100 & GA-100si models	23
TROUBLESHOOTING	
General Information	24
Decrease in suction strength	25
Vacuum will not start	27
Vacuum will not stop	28
WARRANTY INFORMATION	
Limited Lifetime Warranty	29

SCHEMATIC - GA-40

1. Circuit Breaker
2. Serial Number
3. Low Voltage Connector
4. Air Exhaust
5. Air Intake
6. Muffler (optional)

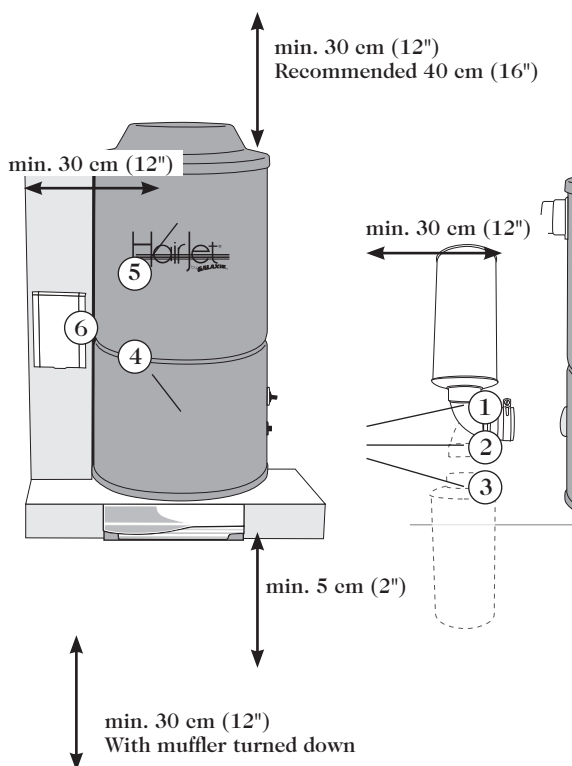

SCHEMATIC – OTHER MODELS

1. Circuit Breaker
2. Information Center (*si* models only)
3. Low Voltage Connector (GA-80 with LED)
4. Serial Number
5. Air intake (GA-100 + GA-100i only)
6. Air Intake
7. Air Exhaust
8. Muffler (optional)

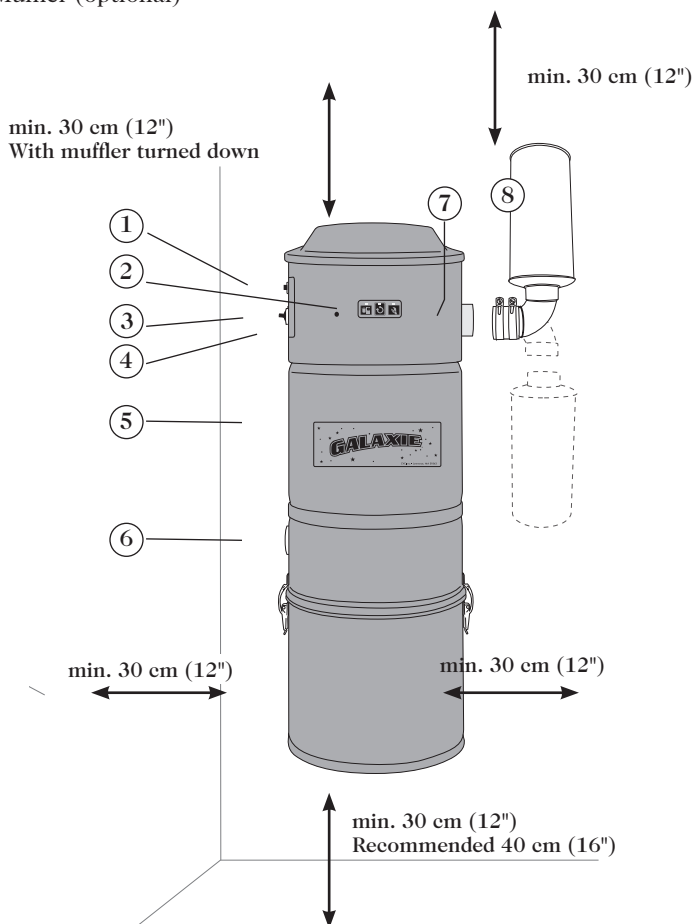

UNIT INSTALLATION

Using the mounting plate provided with your vacuum cleaner, secure the unit to the wall (**figure 1**), at a height allowing easy access for maintenance of the filters, dirt receptacle and/or bags (see pages 6 and 7).

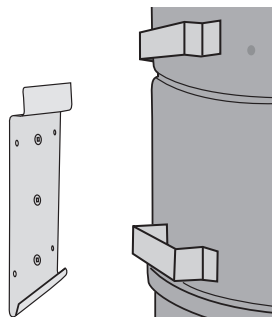

figure 1

The connections to the piping system will require some basic tools: a mitre box and small saw or a pipe cutter (**figure 2**). See pages 9 and 10 for general instructions pertaining to the preparation of PVC pipes. To simplify matters, installation kits, including necessary fittings, pipes, glue and wiring, as well as a detailed instructions booklet, are available from Galaxie service centers.

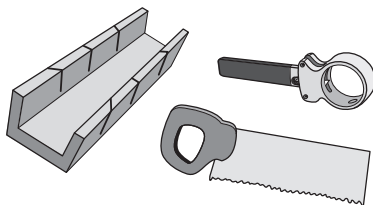

figure 2

Contrary to all other connections in the piping system, **do not glue the last fitting to your unit**. Galaxie central vacuums are equipped with an adjustable air intake valve (**figure 3**), which does not require glue. An airtight fit is achieved with the screw-type adjustment on the fitting itself.

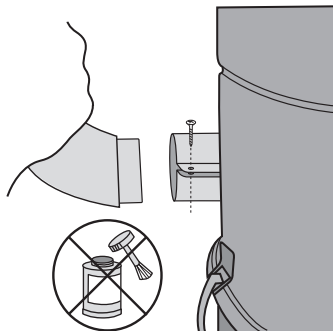
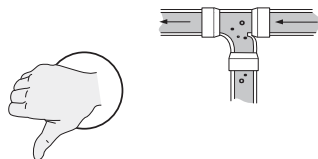
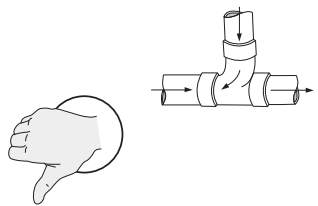
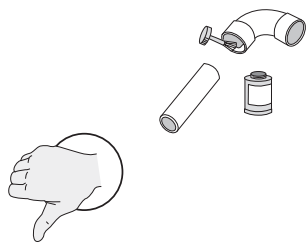
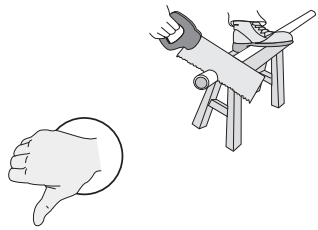
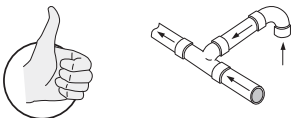
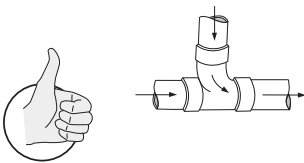
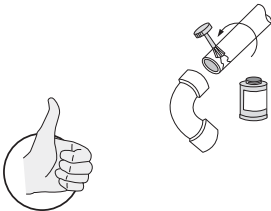
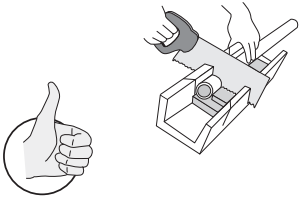
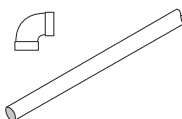
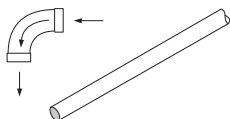
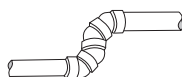
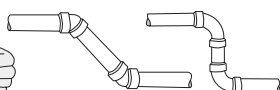
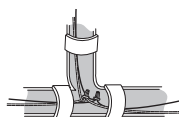
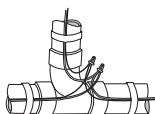
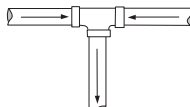
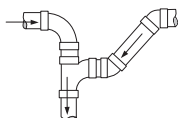

figure 3

INSTALLING PIPING



DOS & DON'TS



INSTALLING INLETS

When installing your vacuum inlets, we recommend that the principle of electric polarity be taken into account. Ensure that the wire connected onto contact A on inlet 1 is the same as that connected to contact A on inlet 2, and so on. Do not cross, reverse or interchange wires.

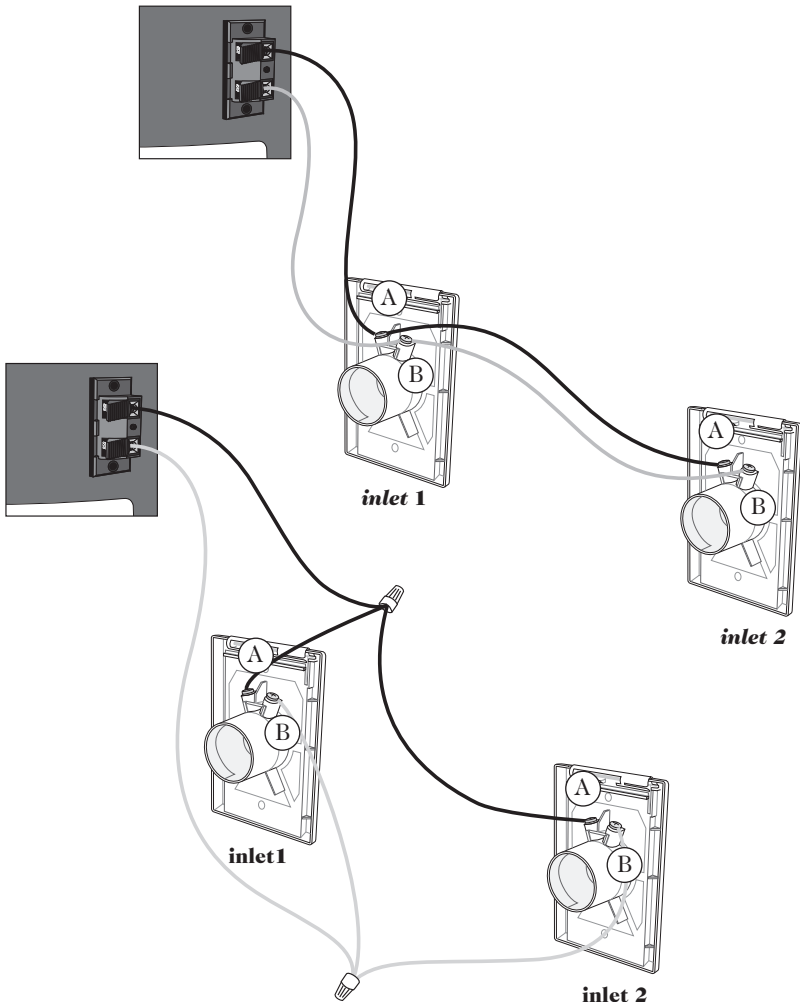

MUFFLER INSTALLATION (OPTIONAL)

1. Insert the rubber coupling on the vacuum air exhaust.
2. Using a Phillips screwdriver, tighten the clamp collar to ensure adequate sealing.
3. Insert the 90° elbow into the rubber coupling, and tighten clamp collar as per instructions in step 2.
4. Apply ABS glue to the 90° elbow and insert muffler.

GA-40 MODEL

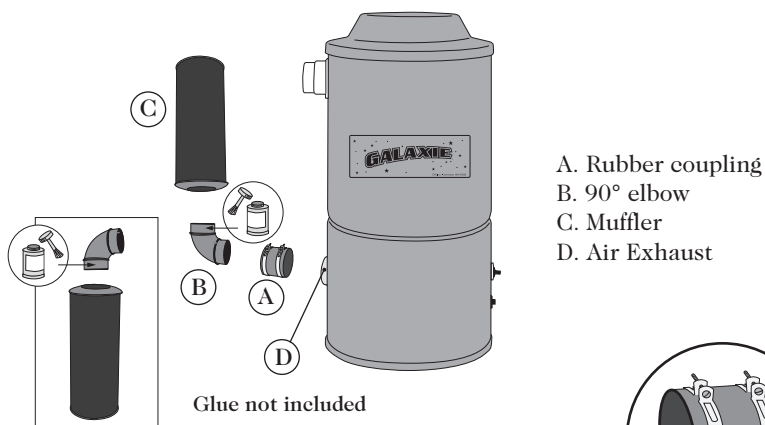

OTHER MODELS

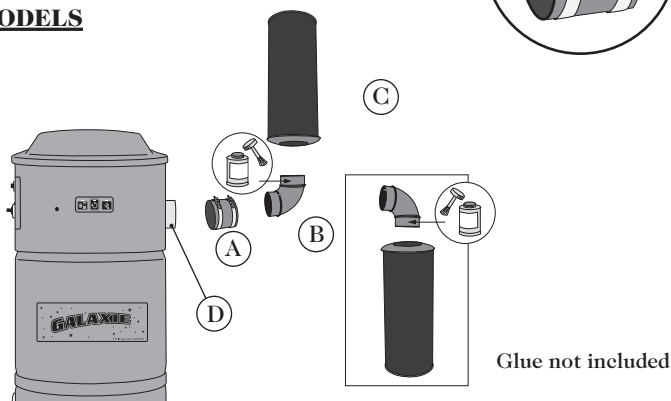







MUFFLER INSTALLATION (GA-240 MODEL)

WARNING

Your central vacuum is a high performance unit, equipped with two high output motors, where maximum performance requires a specific installation:

- Connection to a 220/240 volts outlet (Type Nema 16R in North America)
- Installation in a well-ventilated room of at least 75 square feet (7 m²)
- Exhaust connection to metal piping system, with **outdoor venting** (see details below).

Be informed that an improper installation could reduce the unit's performance and durability, and even invalidate the warranty.

Included	GA-240
	1 x 41" • 104 cm
	1 x
 ①	2 x
 ②	4 x
	1 x
	1 x

MUFFLER INSTALLATION (GA-240 MODEL)

Before installing muffler, be sure that it is preceded by at least 36 inches (91 cm) of metal piping.

1. Insert the rubber coupling on the vacuum air exhausts or pipe.
2. Using a Phillips screwdriver, tighten the clamp collar to ensure adequate sealing.

* To be vented outside

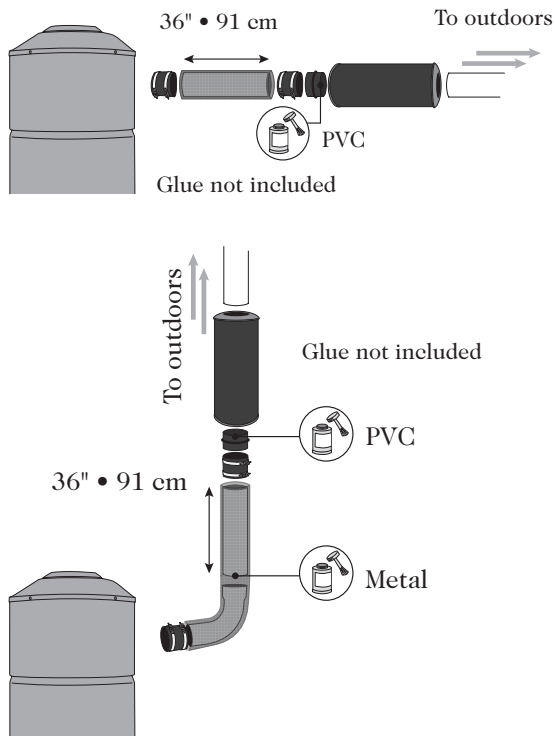

CAUTION: When power unit is operational, metal exhaust pipe can become very hot; that's why we recommend that you install the provided rubber sleeve on it.

There should be an electric outlet within 1 meter (3 feet) of your central vacuum unit. Once the appliance is installed in a suitable location, connect your central unit to an electric outlet on an ***dedicated* grounded circuit***. Do not use extension cords or modify the length of your vacuum cleaner's power cord.

DEDICATED* GROUNDED CIRCUIT

- **North America**

120 V / 240 V all models : 20 A

- **European continent and other**

220 V / 240 V models GA-40, GA-80 : 8A

220 V / 240 V model GA-100, GA-100si, GA-200si : 10 A

220 V / 240 V models GA-240si : 10A

Your central vacuum cleaner has a thermal safety device or a circuit breaker to protect against any over voltage or electrical defect. If that protection should fail, contact your authorized service center.

* Please reserve a circuit breaker dedicated only to the connections for your central vacuum.

If you find that installing your vacuum cleaner is too difficult, ask your service center to install it for you. When in doubt, it is better to have the work done by a professional and ensure that the unit is properly installed. Any installation that does not comply with the specified norms could alter or invalidate the warranty.

GROUNDING INSTRUCTIONS

This appliance must be grounded. If it should malfunction or break down, grounding provides a path of least resistance for electric current to reduce the risk of electric shock. This appliance is equipped with a cord having an equipment-grounding conductor and grounding plug. The plug must be inserted into an appropriate outlet that is properly installed and grounded in accordance with all local codes and ordinances. No adaptor should be used with this appliance.

WARNING

Improper connection of the equipment-grounding conductor can result in a risk of electric shock. Check with a qualified electrician or service person if you are in doubt as to whether the outlet is properly grounded. Do not modify the plug provided with the appliance – if it will not fit the outlet have a proper outlet installed by a qualified electrician.

120 V MODELS

This appliance is for use on a nominal 120 V circuit, and has a grounded plug (**figure 4**). Make sure that the appliance is connected to an outlet having the same configuration as the plug. No adaptor should be used with this appliance.

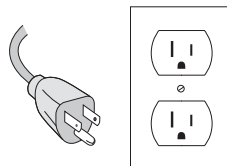
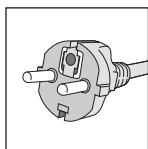

figure 4

220 V/240 V MODELS

This appliance is for use on a circuit having a nominal rating more than 120 V and is factory-equipped with a specific cord and plug to permit connection to a proper electric circuit. Make sure that the appliance is connected to an outlet having the same configuration as the plug. No adaptor should be used with this appliance. If the appliance must be reconnected for use on a different type of electric circuit, the reconnections should be made by a qualified service person



Type C

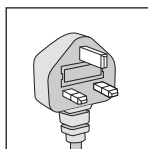

Type G

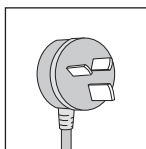

Type H

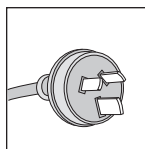

Type I

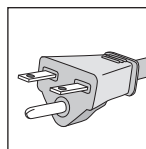

Nema 6-15 R

LOW VOLTAGE CONNECTIONS

Connect the low voltage wires to the low voltage connector on your unit.

To do so:

1. Strip wires over 1 cm ($\frac{1}{2}$ inch) (**figure 5**).
2. Gently press on the toggle to open the connector (**figure 6**).
3. Insert stripped wire (**figure 7**).
4. Release toggle to secure wire in connector (**figure 8**).
5. Repeat for second wire.

To disconnect:

1. Gently press on the toggle to open the connector.
2. Remove low voltage wire from connector.

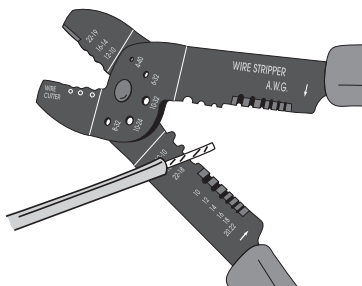

figure 5

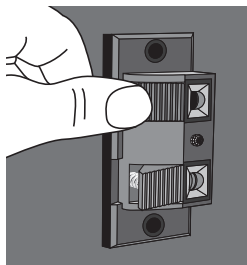

figure 6

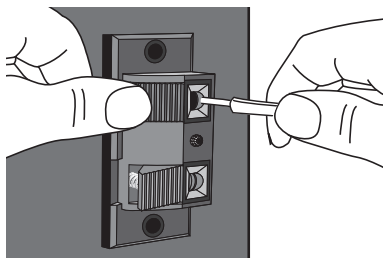

figure 7

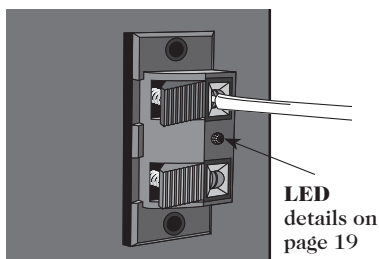

figure 8

HOSE HOOK-UP & INLETS

Before operating your central vacuum...

Please verify that it is properly connected to the piping system, and to a grounded electrical outlet, and that the low voltage wires are connected to the unit (see pages 8 to 16). Then read the complete owner's manual and proceed with a quick verification of your unit's installation:

- Check filter and bag if applicable to be sure they are properly installed.
- Check rubber seals in each vacuum inlet.

If using an On-Off hose...

To start your central vacuum, simply insert the hose in the vacuum inlet of your choice. Please ensure that the tab on the hose end is properly lined up with the slot in the inlet opening (**figure 9**). If your hose handle has an integrated on-off switch, simply slide the switch to the "on" position.

Do not try to open another inlet while your system is in operation, as it may damage the inlet's rubber seal.

- While the hose is still plugged into one inlet and the system is operational, check other inlets for leaks.
- Plug the hose into each vacuum inlet to ensure that each one works properly.

If using a standard hose...

Simply insert in inlet to start vacuum.

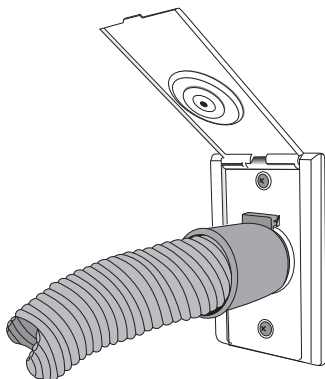

figure 9

PROGRESSIVE START

GA-80si, GA-100si, GA-200si & GA-240si

Each model is equipped with a special module allowing for a smooth and gradual start-up of the vacuum system, in order to prolong motor durability.

AUTOMATIC STOP

GA-80si, GA-100si, GA-200si, & GA-240si

In case you've forgotten to turn off your vacuum, or it's been turned on by mistake, your vacuum system will automatically shut off after one hour of uninterrupted use. Simply restart the vacuum system with the switch on the hose handle.

LED INDICATOR

GA-40 & GA-80 MODELS

LED – On low voltage connector

Steady green – indicates unit is connected to a power source.

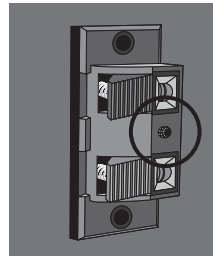

INFORMATION CENTER

GA-80si, GA-100si, GA-200si, & GA-240si

Your central vacuum unit is equipped with an electronic timing device which will recommend proper maintenance of your vacuum system. These signals are only suggestions and will not indicate a problem with your vacuum system. They will not stop or hinder the use of the vacuum.

- ◆ Flashing LED - Empty dirt receptacle or change bag.
- ◆◆ Press to stop the flashing LED.
- ◆ Flashing LED - Maintenance of the power unit is required.



Please note that **Galaxie motors do not require lubrication**. Each motor contains two carbon brushes which will wear normally, and may eventually require replacement. For warranty purposes, this should be done by an authorized service center. Brush life is affected by the number of hours used, frequency of start-ups and shut-downs, humidity, altitude, and temperature. In order to avoid damage to the motor itself, brushes should be replaced before they are completely worn out. We therefore recommend that you have your unit and motors inspected by a service center every 5-6 years.

MAINTENANCE – GA-40

Change the bag when the one in place is full. Frequency will depend on the use of the unit.

1. To access the bag, lift and remove the unit's top cover.
2. Remove the used bag and seal bag opening (adhesive seal provided on each bag). Discard used bag.
3. Install the new bag, ensuring the tabs on the bag adaptor are aligned with the slots in the bag collar (**figure 10**).
4. Ensure adequate sealing by inserting bag as far as the retention ring (**figure 11-A**). Rotate bag 20° (**figure 11 - B**) to ensure tabs on bag adaptor are no longer aligned with the slots in the bag collar.
5. Replace the unit's top cover.

The disc-shaped filter (**figure 12**), located between the dust bag and the motor, should be changed once for every three bags, or more often as needed.

Part Number :
Model GA-40 – TDSAC43G

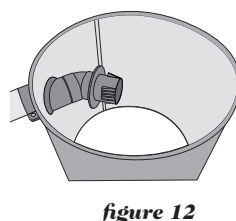
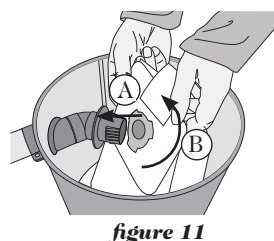
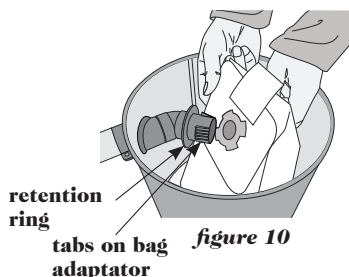

Change the bag when the one in place is full. Frequency will depend on the use of the unit. For the GA-200 model, the integrated monitor will indicate when to empty the canister. These indications are provided by an electronic timing board only as a reference guide.

1. To access the bag, unlatch the two clips and remove the dirt receptacle (**figure 13**).
2. Remove the used bag and seal bag opening (adhesive seal provided on each bag). Discard used bag.
3. Install the new bag, ensuring the tabs on the bag adaptor are aligned with the slots in the bag collar (**figure 14**).
4. Ensure adequate sealing by inserting bag as far as the retention ring. (**figure 15-A**). Rotate bag 20° (**figure 15 - B**) to ensure tabs on bag adaptor are no longer aligned with the slots in the bag collar.
5. Replace dirt receptacle and seal by latching both clips.

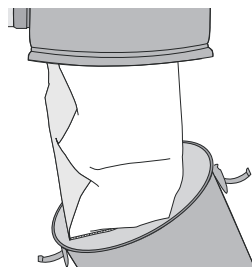

figure 13

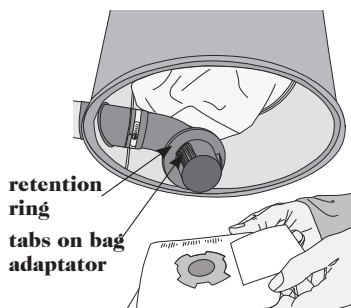

figure 14

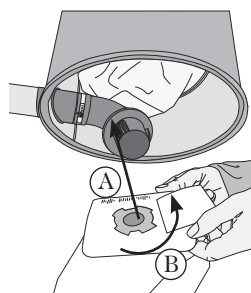

figure 15

Part number :
Models GA-80 & GA-200 – TDSAC93G

We recommend you empty the dirt receptacle and clean the separator four times a year, depending on use of your central vacuum. For the GA-100si model, the integrated monitor will indicate when to empty the dirt receptacle. These indications are provided by an electronic timing board only as a reference guide.

1. To empty the dirt receptacle:

Disconnect the unit from the electric outlet. Unlatch the two clips, remove the receptacle (**figure 20**), and empty into an appropriate container.

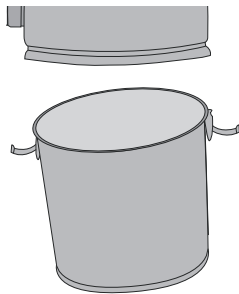

figure 20

2. To clean the separator (**figure 21 & 22**)

A guard screen, referred to as a separator, is located directly above the dirt can inside the power unit. It is located on a disc and held in place by a wing nut. **This screen should be inspected once a month, and cleaned whenever debris has collected on screen. Failure to clean screen can result in loss of suction.**

To clean screen, remove wing nut and lower disc. Brush screen off and remove all lint, debris, hair etc. Replace screen and hand tighten wing nut. **Do not run your Galaxie Central Vacuum Unit without separator.** Experience has shown that when cleaning new carpets for the first few times, it is advisable to check the separator and dirt can at more frequent intervals.

Much excessive loose lint and nap, normal in all new carpets, is removed in these early cleanings, and some will tend to settle on the separator screen, allowing a build-up that will impair the suction power unless removed.

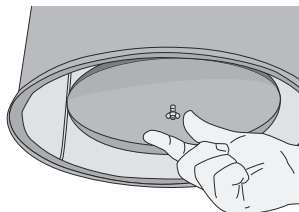

figure 21

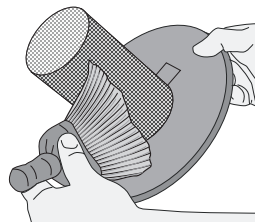

figure 22

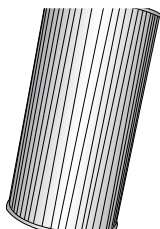

figure 23

3. To change the optional cartridge filter (figure23), remove wing nut and lower disc. Change filter and replace disc and hand tighten wing nut.(figure21, p23).

GENERAL INFORMATION

If the vacuum unit does not work, check the fuse or breaker on the unit and/or in the electrical panel in your home, and replace any defective part(s) as deemed necessary. Please verify that the unit has been installed properly, according to the instructions in this manual.

Your vacuum cleaning system is designed to collect everyday dry matter (dust). It is approved by authorized testing agencies for dry use only. Do not use on wet surfaces.

Should you accidentally vacuum liquids, immediately unplug the unit from the electric outlet, then empty and wipe the dirt receptacle with a dry cloth. Then operate the system from the vacuum inlet through which you vacuumed the liquid, in order to eliminate all moisture in the piping system.

We strongly recommend against vacuuming abrasive materials such as cement, plaster and sheetrock dust. This fine dust could work its way into the motor, causing considerable damage. Should you do so inadvertently, immediately clean the filters and, as a precautionary measure, contact your authorized service center to determine the extent of the damage to the unit.

Remember that in order for your warranty to remain valid, maintenance of the motor and repairs to the unit itself must be carried out by an authorized service center, using original Galaxie parts.

TROUBLESHOOTING

PROBLEM	POSSIBLE CAUSE	CORRECTIVE ACTION
Decrease in suction strength	Dirt receptacle / Bag is full	Empty dirt receptacle / change bag (see page 20 to 21).
	Dirt receptacle is not properly attached	Check clamps holding dirt receptacle to make sure they are tight, and dirt receptacle is aligned.
	Open vacuum inlet	Close all vacuum inlets not in use.
	Exhaust line is clogged	Verify that no object is blocking the exhaust.
	Blocked hose	Plug the handle end of the hose into the suction inlet, thus reversing the suction in the hose. Cover the gap around the handle, to ensure suitable suction strength, and ensure contact with inlet contacts to start the unit. This should clear the hose.

TROUBLESHOOTING

PROBLEM	POSSIBLE CAUSE	CORRECTIVE ACTION
Decrease in suction strength (cont.)	Obstruction in the piping system	Remove the screw from the air intake connector, to free the central vacuum unit from the piping system (see figure 3 on page 8). Start the unit by plugging the hose into a vacuum inlet. By placing your extended hand over the air intake opening on the unit, check the suction strength on the unit itself. If suction strength is normal, the obstruction is in the piping system. If suction strength is diminished or completely absent, have the unit checked by an authorized service center.
	Separator is covered with debris	Clean separator (see page 23)

If none of these suggestions restores suction strength, contact your authorized service center.

TROUBLESHOOTING

PROBLEM	POSSIBLE CAUSE	CORRECTIVE ACTION
Vacuum will not start	The electrical power is not connected properly	Ensure that the power cord is plugged into a dedicated grounded electrical outlet, according to specifications on page 17..
	Low voltage wire not connected properly	Check the low voltage wires to make sure they are properly inserted into the low voltage connector as per instructions on page 17..
	Faulty vacuum inlet	Start the vacuum unit from other inlets in your home to identify the defective inlet.
	Unit circuit breaker is off	Press the reset button to reset the unit circuit breaker. If unit restarts and automatically shuts off shortly after, contact an authorized service center.
	In-house circuit breaker is off	Reset the circuit breaker in your electrical panel. Verify that your central vacuum unit is connected on a dedicated grounded circuit (see pages 15 and 16)..
	Defective on-off hose	Turn the hose ¼ turn in the vacuum inlet. If unit starts, have the vacuum hose checked by a certified service center.

TROUBLESHOOTING

PROBLEM	POSSIBLE CAUSE	CORRECTIVE ACTION
Vacuum will not stop	On-off hose improperly inserted into vacuum inlet	Ensure that the hose end is properly placed in the vacuum inlet: the tab on the hose should fit into the slots on the inlet to ensure adequate contacts for the hose switch to function (see page 18)..
	Defective on-off hose	If the hose is properly placed in the vacuum inlet, and the unit continues running despite the fact that the hose switch is in the “off” position, have the hose checked by a service center.
	Low voltage wire not connected properly	While vacuum is on, unplug low voltage wires from unit. If vacuum stops, there's a faulty low voltage wire. Contact your installer or authorized service center.

WARRANTY INFORMATION

This warranty is valid for domestic use only.

LIMITED LIFETIME WARRANTY

Your Galaxie vacuum system is protected by a lifetime warranty. We guarantee that the unit canister will be exempt of any material or manufacturing defect. This warranty is valid from the date of purchase, for as long as you are the original owner, and the system remains at its original place of installation.

The motors and electrical components are guaranteed for a period of 5 years. For the GA-100si, GA-200si and GA-240si models, they are guaranteed for 10 years or 500 hours of use.

For all models, our authorized service center will repair or replace (at Galaxie's discretion) the defective part or parts, free of labor costs, for a period of 1 year.

In order to maintain your warranty, all repairs must be made by an authorized Galaxie service center, with original Galaxie parts. Failure to do so could void the warranty.

This warranty excludes normal wear and tear of certain parts such as filters, damages caused (according to Galaxie) by abusive use (ex.: sheetrock dust, water, etc.), commercial use, the lack of appropriate maintenance, inadequate installation, negligence, natural disasters, accidents, and acts of God.

NOTES

This image shows a full page of blank handwriting practice paper. It features evenly spaced horizontal blue lines across the entire page, providing a guide for letter height and placement. There are no margins, text, or other markings present.

[illegible]



CENTRAL VACUUM

For parts or service on your
Galaxie Central Vacuum System call:

CVC Incorporated 1-800-238-2294

Or

Your local authorized Galaxie Central Vacuum Dealer

CVC Incorporated, 16 - 18 Ballard Road • Lawrence MA 01843
www.galaxie-vac.com © 2005 C.V.C. Incorporated